

Request No.: N1533350U
Date: 20 DEC 2023

Dear Sir/ Mdm

APPLICATION FOR SEWERAGE INFORMATION PLAN (SIP) ON LOT MK02-01066P

1. The information shown in the attached SIP are indicative. The exact position, alignment, levels of and lateral connections to the sewers and manholes must be verified on site before commencement of any construction works or specified activities within the sewer corridors (refer to Annex for more information). Please note that it is an offence under the Sewerage and Drainage Act S13A(1)(b) for any person who breaks any ground without physically ascertain the location of any public sewerage system in the vicinity of the works.
2. Please consult PUB's Water Reclamation Network Department at Tel 6731 3294 when you are unable to locate the existing sewers/pumping mains/manholes/chambers, etc at site.
3. If there is no existing public sewerage system serving the site, the Qualified Person (QP)/Owner may be required to extend the sewerage infrastructure. Please consult PUB.
4. Please note that not all sanitary drain-lines are indicated in the attached SIP. Where a drain-line is not shown in the SIP but found on site, please verify their alignment on site including those that may be serving neighbouring premises and ensure they are protected from damage before commencing works on site.

This is a computer-generated document. No signature is required.

General Requirements for Development Control (DC), Detailed Plan (DP) and Protection of Water and Sewer Pipes (POWS) Submissions

1. For development works, a QP shall obtain PUB's DC clearance prior to making DP submission to PUB for sanitary/sewerage works. The QP is also required to obtain PUB's DP clearance for the development prior to commencement of sanitary/sewerage work on site.
2. PUB simplified submission scheme offers a shorter processing time for simple development works compare to the normal DC submission. The QP may opt to lodge their proposal if the proposed development work complies with criteria of simplified submission. Please refer to <https://www.pub.gov.sg/compliance/qualifiedpersonsportal/processflow>
3. The QP shall take note of the guidelines below in developing the DC plan and is advised to make pre-consultation with PUB (Building Plan Division) concerning the proposed sewers & sewer connections before submitting the DC plan to PUB for approval.
 - a) No structure or buildings shall be placed over or across any sewer or manhole without PUB's approval. Please refer to clause 1.2.5 of Code of Practice on Sewerage and Sanitary Works (2nd Ed - Jan 2019, Addendum No. 1 - Mar 2021) for the minimum setback distance which all structures shall maintain from the sewers.
 - b) The internal sanitary drainage system (e.g., drain-line) serving the development shall be connected to the public sewer at the connection point(s) approved by PUB. If the new connection extends beyond the development lot boundary, the developer shall obtain the consent of the owner of any affected land for the proposed connection.
 - c) For development with multiple lots, e.g., detached or terrace houses on individual lots (not landed strata housing), every lot shall be provided with an individual drain-line connection to the public sewer.
 - d) For new development & redevelopment, all existing drain-line connection going into neighbouring premises shall be discontinued where direct connection to public sewer in public area is feasible. The QP shall ensure that the existing drain-line is properly sealed after the completion of the new drain-line connection and verification that there are no other connections from neighbouring premises to the drain-line to be abandoned.
 - e) Where an existing drain-line connection is proposed to be reused, it is allowed if the existing drain-line connection have the adequate capacity and is in good condition to serve the development. A CCTV survey report & video shall be submitted to show that the existing drain-line connection is in good condition.
4. For all site activities and construction works, Contractors and QPs shall take note of the guidelines below for the protection of sewers.
 - a) No works either permanent or temporary shall be carried out within the public sewer corridor without a written permission from PUB. A submission shall be made online via <https://bpu.pub.gov.sg/pows> to seek PUB's permission to carry out any specified activities (listed below) proposed within public sewer corridor or any works outside public sewer corridor that are likely to affect the public sewerage system.
 - b) Before commencing the specified activities/works, a PUB registered CCTV contractor shall be engaged to carry out a pre-construction CCTV inspection of the affected sewer and submit the CCTV survey report & video to PUB.
Note: For small scale redevelopment/A&A works for single landed property (terrace, semi-detached and detached house), pre-construction CCTV inspection is not required. Only the post-construction CCTV survey report & video of the affected sewer is required to be submitted.
 - c) On completion of the specified activities/works, another CCTV inspection of the affected sewer shall be carried out to confirm that there is no damage to the affected sewer. The submission of this post-construction CCTV survey report & video shall be made by the engaged CCTV contractor. For development works, this shall be done before QP applies for sewerage clearance for TOP/CSC (PUB-BPU-COMPOFWORK).
 - d) Please refer to https://www.pub.gov.sg/Documents/WRN_AdvisoryNotes.pdf for more details on the prevention of damage to the sewerage system and the submission requirements and procedures.

Public Sewer Corridor and List of Specified Activities

A public sewer corridor refers to the land and space bounded by 2 vertical planes as illustrated below, through which any sewer, main or pipe of the public sewerage system runs.

Public Sewers	Distance X on either side from the centreline
DTSS tunnels	40m
Sewer \geq 900mm in Diameter	20m
Sewer < 900mm in Diameter	10m

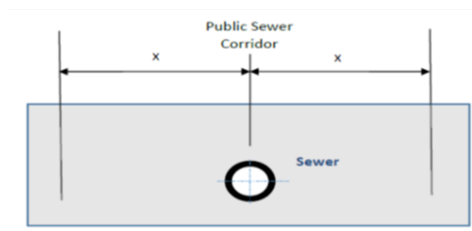

The following is the list of specified activities that require PUB's permission before they can be carried out in a public sewer corridor.

- the carrying out of any earthwork for site formation, whether by excavation, filling or backfilling;
- the excavation of any trench, well, pond or pool, or excavation for any underground structure which is more than 0.5m in depth;
- the excavation of earth, rock or other material by means of explosives;
- the carrying out of any ground exploratory or testing works including through soil boreholes and geological surveys;
- the installation of any foundation, sheet-piled foundation, earth retaining or stabilising structure, ground anchor, horizontal tie-back or any other similar installation;
- the carrying out of any ground stabilising work including jet grouting, soil compacting, ground freezing, ground water recharging etc;
- the carrying out of any tunnelling, pipe jacking, mining or subterranean excavation of earth/rock;
- the erection of any permanent or temporary structure including any site office or show flat;
- the installation of any heavy construction machine/plant including the stacking and installation of any concrete block for pile testing; and
- the installation of any container box.

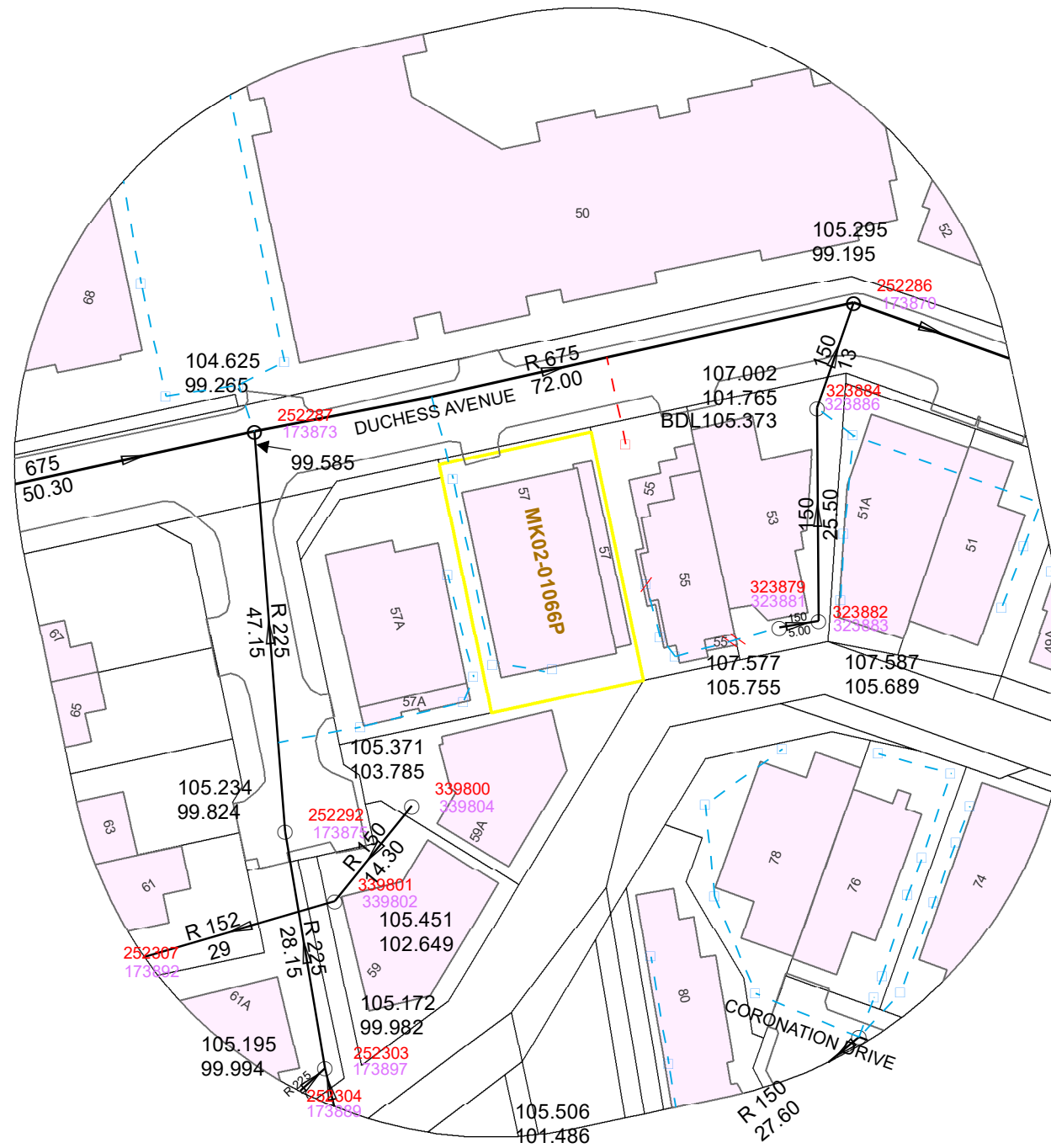

SEWERAGE INFORMATION PLAN

THE INFORMATION GIVEN ON THIS SEWERAGE INFORMATION PLAN FORMS THE BEST INFORMATION AVAILABLE ON THE DATE PRINTED AND IS LIABLE TO CHANGE WITHOUT NOTICE WHILST EVERY ENDEAVOR IS MADE TO ENSURE THAT THE INFORMATION PROVIDED IS CORRECT, THE PUB DISCLAIMS ANY LIABILITY FOR ANY DAMAGE OR LOSS THAT MAY BE CAUSED TO ANY PERSON DIRECTLY OR INDIRECTLY AS A RESULT OF ANY ERROR OR OMISSION.

CAUTION:
The information given is INDICATIVE only and shall be verified on site. For proposed sewer / pumping main / DTSS, please consult PUB for the latest details and status

SCALE
(in A3 Size)
1:750

LEGEND :			REHABILITATED SEWER		EXISTING PUMPING MAIN		EXISTING SLUDGE MAIN		LEFT-IN CAISSON
	EXISTING SEWER		ABANDONED SEWER		DECOMMISSIONED PUMPING MAIN		ABANDONED SLUDGE PUMPING MAIN		LEFT-IN SHEET PILES
	UNSURVEYED SEWER		SEWER TO BE ABANDONED (NO CONNECTION TO THIS)		PROPOSED PUMPING MAIN		PROPOSED DTSS TUNNEL (CONSULT PUB FOR THE LATEST DETAILS AND STATUS)		RC TRENCH
	DECOMMISSIONED SEWER		SEWER IS ALLOWED		ABANDONED PUMPING MAIN		EXISTING DTSS TUNNEL		IMMEDIATE DOWNSTREAM SEWER GIS ID
	PROPOSED SEWER (CONSULT PUB FOR THE LATEST DETAILS AND STATUS)		PROPOSED DRAINLINE		PUMPING MAIN TO BE ABANDONED		MANHOLE GIS ID		